

# Soils Map

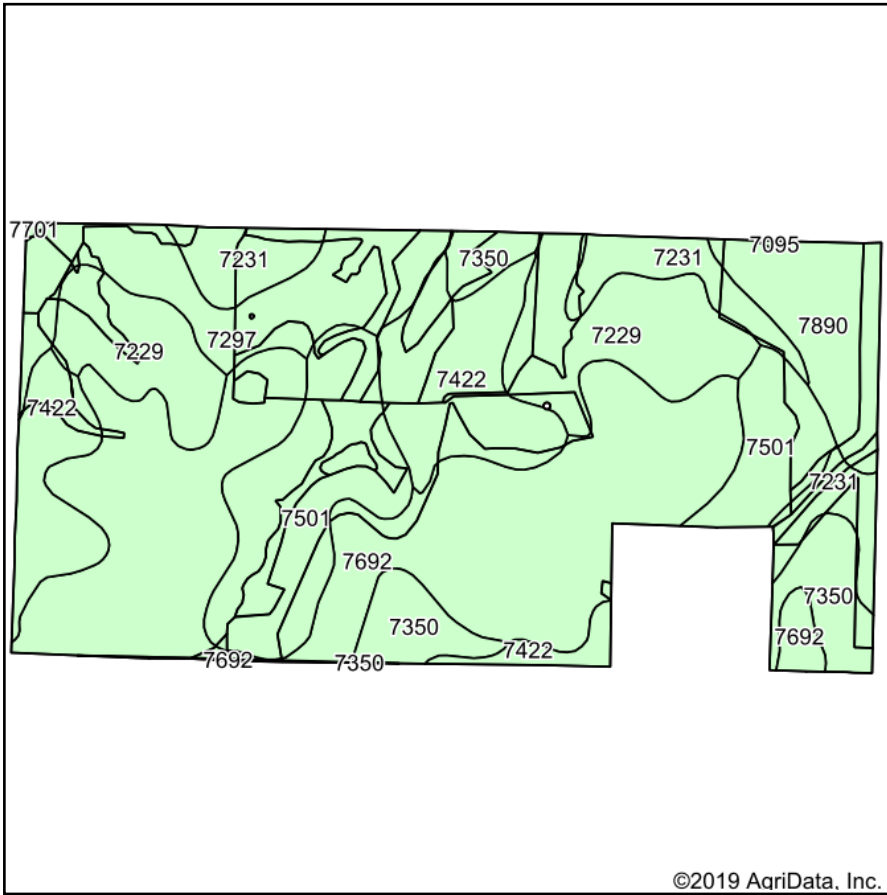

Soils data provided by USDA and NRCS.

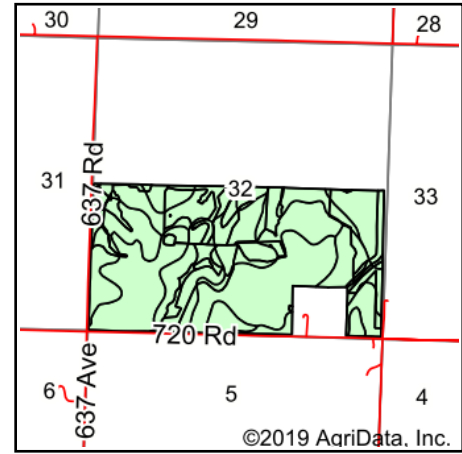

State: **Nebraska**  
 County: **Nemaha**  
 Location: **32-4N-14E**  
 Township: **Bedford**  
 Acres: **295.33**  
 Date: **5/6/2019**

 **The Pinnacle Agency**

FARM MANAGEMENT-REAL ESTATE

Maps Provided By:



© AgriData, Inc. 2019

www.AgrIDataInc.com



Area Symbol: NE127, Soil Area Version: 18

Area Symbol: NE147, Soil Area Version: 17

Code	Soil Description	Acres	Percent of field	Non-Irr Class *c	Irr Class *c	SRPG	Alfalfa hay	Alfalfa hay Irrigated	Corn	Corn Irrigated	Grain sorghum	Grain sorghum Irrigated	Smooth bromegrass	Soybeans	Soybeans Irrigated	Winter wheat	*n Soy
7692	Wymore silty clay loam, 3 to 11 percent slopes, eroded	95.41	32.3%	IIIe	IIIe	70											
7501	Pawnee clay loam, 4 to 8 percent slopes, eroded	41.14	13.9%	IIIe													
7422	Morrill clay loam, 6 to 11 percent slopes, eroded	37.39	12.7%	IVe	IVe	68	4		81		75		5	30		35	
7229	Burchard clay loam, 11 to 17 percent slopes	36.67	12.4%	IVe		64											
7297	Malcolm silt loam, 6 to 11 percent slopes, eroded	26.56	9.0%	IVe	IVe	74	3		75		75		5	27		33	
7231	Judson silt loam, 2 to 6 percent slopes	21.23	7.2%	IIe		80											
7350	Malmö clay, 3 to 11 percent slopes, eroded	18.66	6.3%	IVe		57	3	6	72	127	74	105		27	42	35	
7890	Zook silt loam, occasionally flooded	17.70	6.0%	IIw	IIw	61	5		110	144	98		6	38	45	39	



7692	Wymore silty clay loam, 3 to 11 percent slopes, eroded	0.28	0.1%	Ille	Ille	70										
7701	Ackmore silt loam, occasionally flooded	0.18	0.1%	Ilw	Ilw	72	5		115	149	100		7	42	48	40
7095	Zoe-Zook silty clay loams, occasionally flooded	0.11	0.0%	IVs		53										
<b>Weighted Average</b>						<b>59</b>	<b>1.3</b>	<b>0.4</b>	<b>28.2</b>	<b>16.7</b>	<b>26.9</b>	<b>6.6</b>	<b>1.4</b>	<b>10.2</b>	<b>5.4</b>	<b>12</b>

\*n: The aggregation method is "Weighted Average using major components"

\*c: Using Capabilities Class Dominant Condition Aggregation Method

Soils data provided by USDA and NRCS.